

# gas barbecue

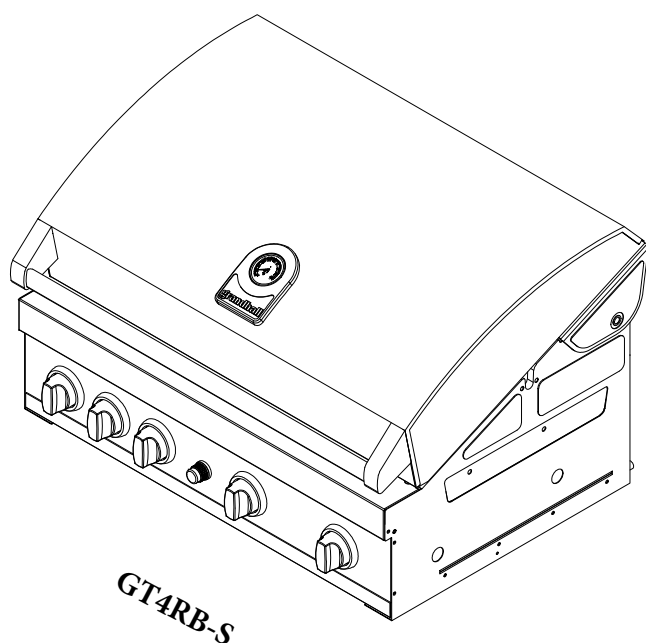

- (IE) (GB) Assembly instructions
- (CH) (FR) Instructions d'assemblage
- (AT) (CH) (DE) Montageanweisungen
- (CH) (IT) Istruzioni per il montaggio
- (BE) (NL) Montage-instructies
- (SE) Monterig
- (FI) Kokoamisohjeet
- (ES) Instrucciones de armado
- (PT) Instruções para Montagem
- (DK) Monteringsvejledning
- (NO) Monterig
- (HR) Upute za montažu
- (SI) Navodila za montažo

PART LIST - GT4RB-S

<i>Ref</i>	<i>Description</i>	<i>Part No.</i>	<i>Qty</i>
1	Lid Assembly	P0014742EA	1
2	Temperature Gauge	P00601484C	1
3	Lid Handle	P00218014R	1
4	Lid Handle Seat (Left)	P03303124A	1
5	Lid Handle Seat (Right)	P03303125A	1
6	Lid Rubber Pad	P05518002I	4
7	Bowl Set	P0076703B4	1
8	Rear Burner Body Set	P02007072A	1
9	Bowl Grease Shield	P06901030B	2
10	Wind Shield - Rear Burner	P069060824	1
11	Heat Shield- Rear Burner	P06905080B	1
12	Grill Plate	P016050076	3
13	Bowl Wind Shield	P0074808R4	1
14	Gas Collector Box with Electrode	P02609055A	3
15	Electric Wire Set	P02615197A	1Set
16	Main Burner	P02008085B	3
17	Flame Tamer	P01708041B	3
18	Valve - Rear Burner- without jet	P03239013A	1
19	Upper control Panel-30mbar	P81109332J	1
	Upper control Panel-50mbar	P81109333J	1
20	Control Panel-30mbar	P0291593IS	1
21	Gas Valve Heat Shield	P0300819DG	1
22	Main Valve-without jet	P03239012A	3
23	Manifold	P05006162A	1
24	Gas Valve Heat Shield Bracket	P03327107A	2
25	Control knob - main burner	P03426512V	3
26	Knob Seat	P03415014S	5
27	Control knob - Back burner	P03426522V	1
28	Electric Ignitor	P02502265C	1
29	Grease Tray Handle	P00213039M	1
30	Grease Tray Holder Bracket	P03327111D	1
31	Grease Tray	P02717837D	1
32	HOT PLATE	P05701049H	1
33	Name plate	P00407036A	1
34	Electrode- Rear Burner	P02614025A	1
35	Warming Rack	P01516030K	1
36	Crossfire box	P022123984	2
37	Bowl support bracket- Left	P075140614	1
38	Bowl support bracket- Right	P075140624	1
39	Bowl support bracket- Rear	P075150264	1
40	Aluminum tube- Rear Burner	P03717065B	1
41	Knob Seat Spring	P05504021A	5
42	Searing Burner	P02005032A	1
43	Searing Burner Heat Shield	P0077002B4	1
44	Searing Valve-without jet	P032480095	1
45	Searing Valve Orifice-30mbar	P06517063A	1
46	Searing Burner Electrode	P02614061A	1
47	Searing Burner Electrode Bracket	P033271154	1
48	Adaptor-1/4 LH inlet	P03902031A	1
49	Universal Hose Bar -1/4 LH inlet	P03901024A	1
	Hardware Pack	P06003172A	1

This diagram is provided to assist you identify parts if replacement is necessary. Contact your place of purchase or the manufacturer to inquire about parts, availability and service.

Items included in your barbecue specification may differ from the parts list, depending on region or specific dealer specification.

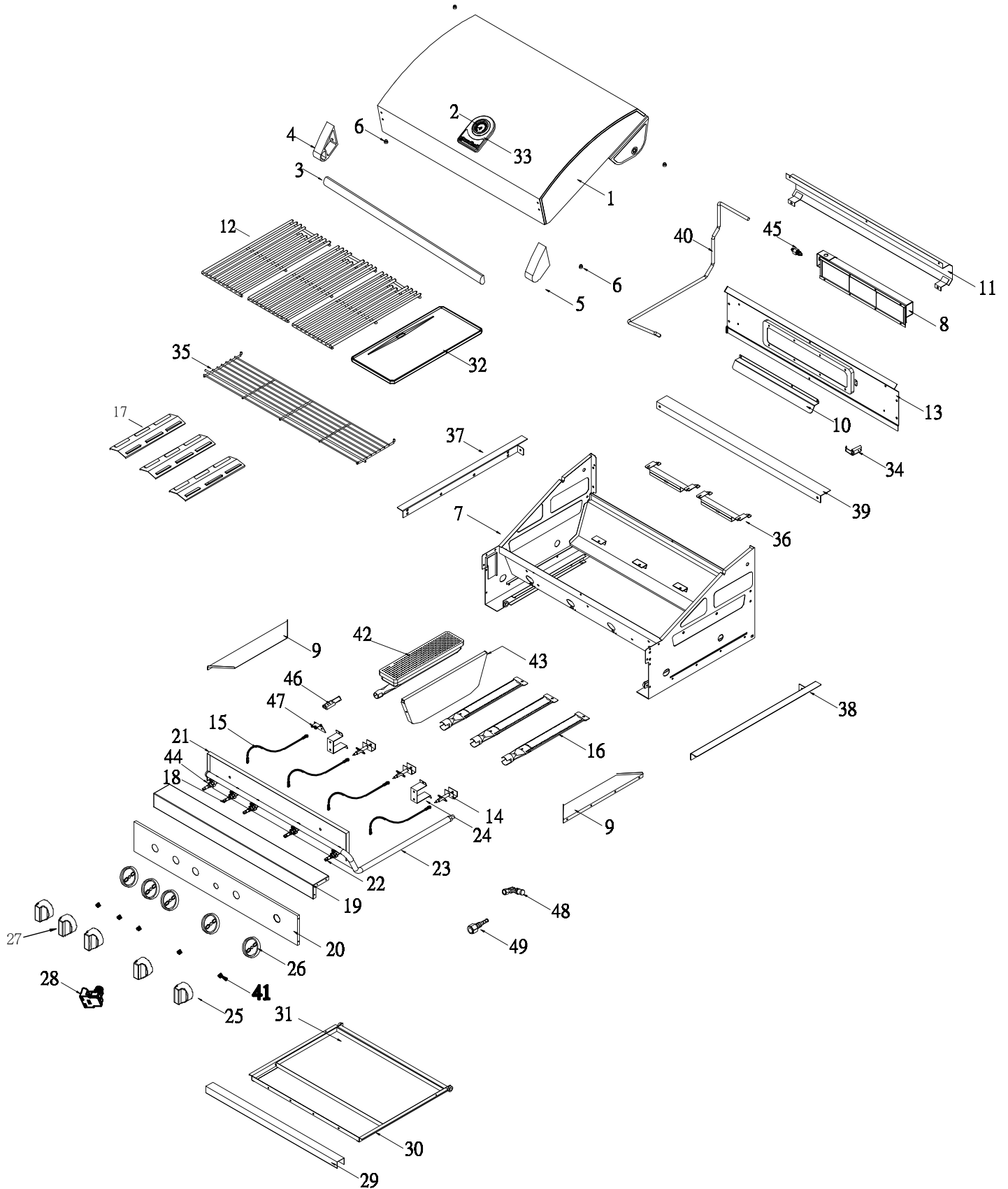

## INJECTOR

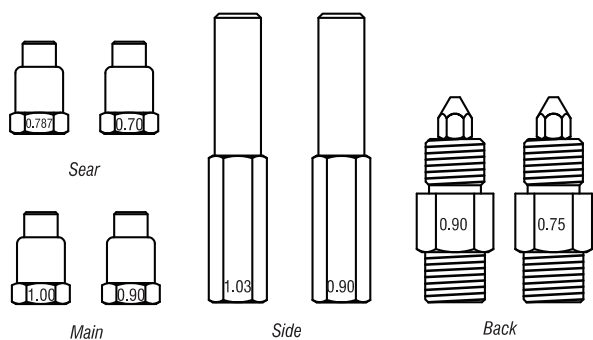

• Main	1.00 mm	- I 3+ (28-30/37)
		- I 3B/P (30)
	0.90 mm	- I 3B/P (50)
• Side	1.03 mm	- I 3+ (28-30/37)
		- I 3B/P (30)
	0.90 mm	- I 3B/P (50)
• Back	0.90mm	- I 3+ (28-30/37)
		- I 3B/P (30)
	0.75 mm	- I 3B/P (50)
• Sear	0.787 mm	- I 3+ (28-30/37)
		- I 3B/P (30)
	0.70 mm	- I 3B/P (50)

## INPUT

• Main	4 burner	16.8 kW	- 1220 grams / h
• Side		4.4 kW	- 319 grams / h
• Back		3.2 kW	- 232 grams / h
• Sear		2.5 kW	- 182 grams / h

## DIMENSIONS

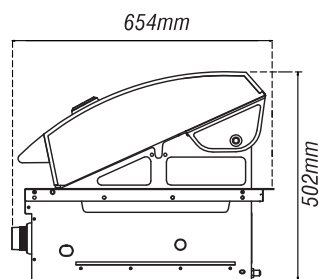
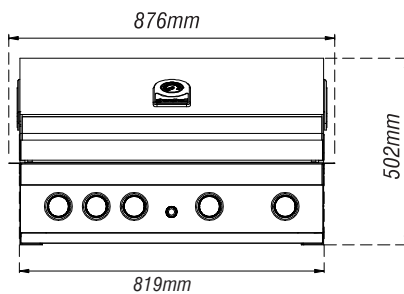
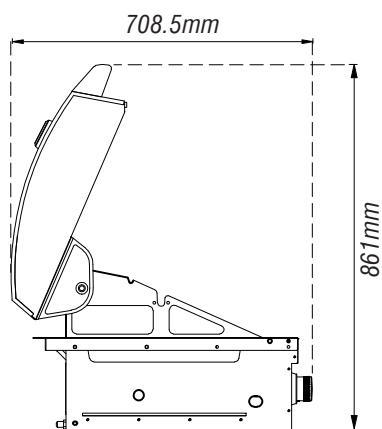

GT4RB-S



## WARNINGS INFORMATION

- MINIMUM CLEARANCES FROM COMBUSTIBLE MATERIALS MUST BE:  
 REAR - 450 mm  
 SIDES - 250 mm  
 TOP - 1000 mm

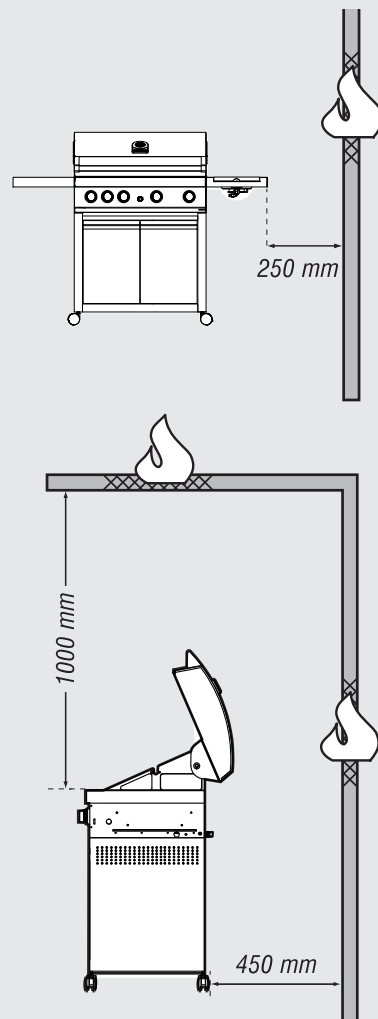

**1. Install the Trim brackets Left and Right & Rear**

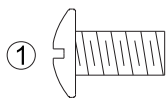

Phillips Head Screw  
1/4"x3/8"  
Qty.4

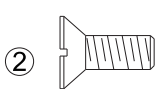

Countersunk Flat Head Screw  
1/4"x3/8"  
Qty.6



Flange Nut 1/4"  
Qty.6

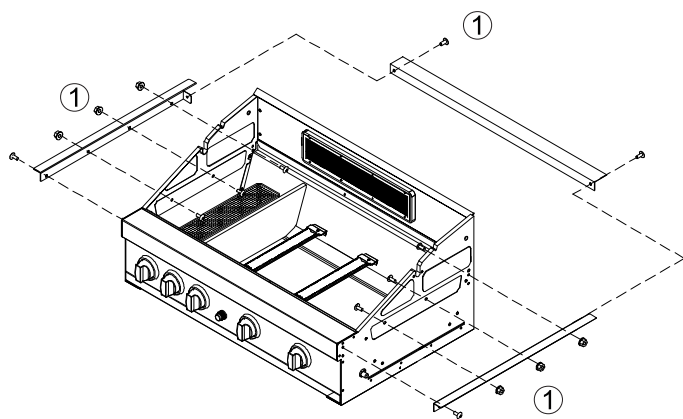

**3. Install Grease Tray**

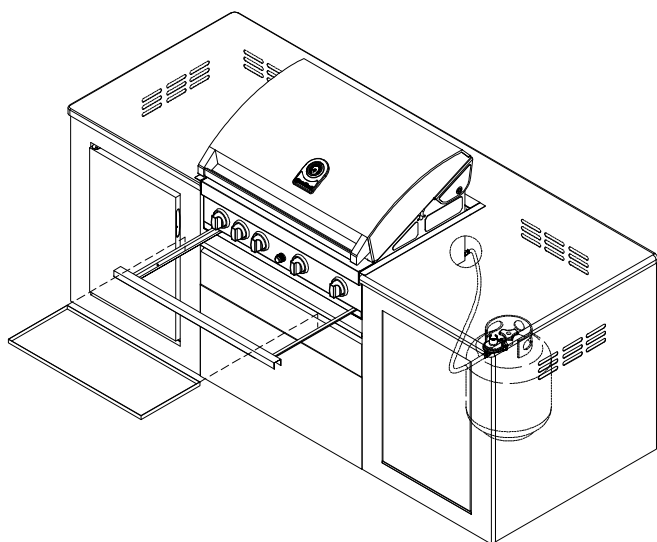

**2. Regulator and Install the grill onto the housing**

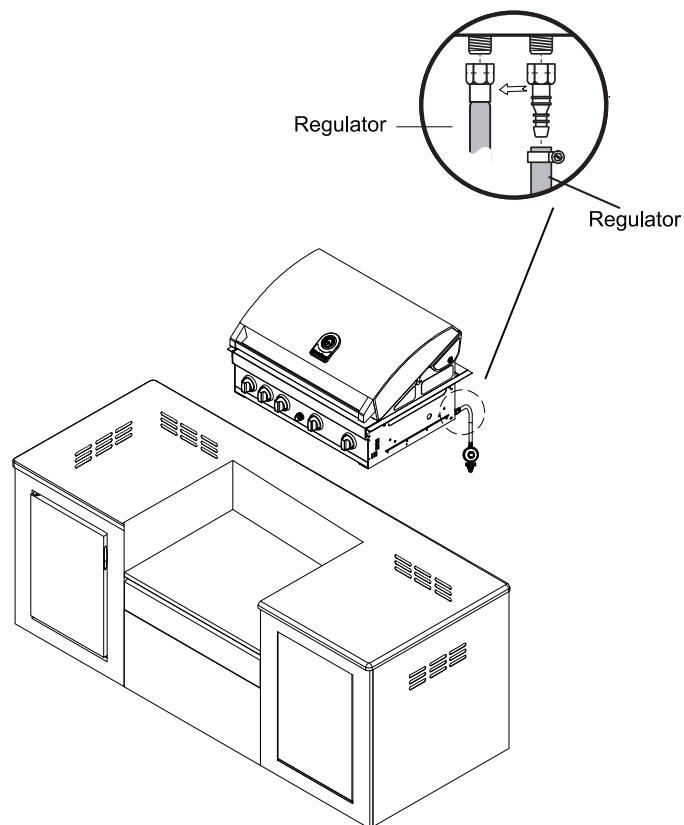

**MOUNTING CUT - OUT**

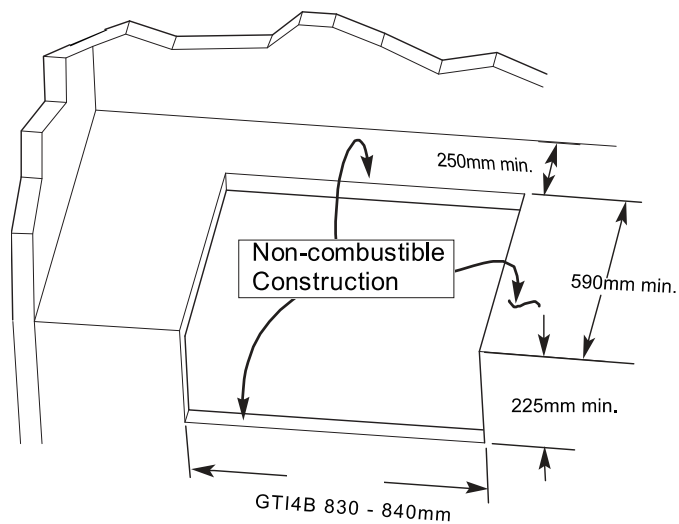

Note: the above illustration is for example only.

## IGNITION BATTERY

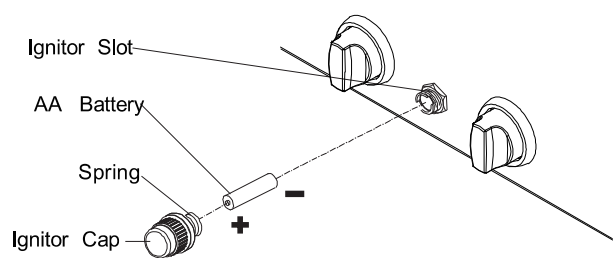

## TEMPERATURE GAUGE

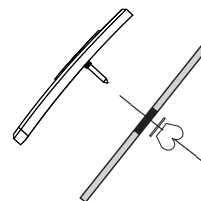

## COOKING COMPONENT INSTALLATION

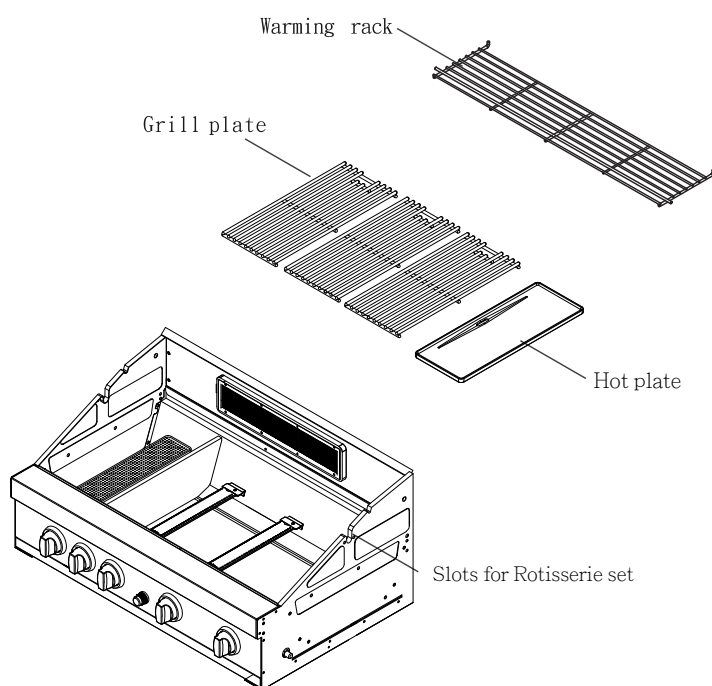

## SIDE BURNER POTS

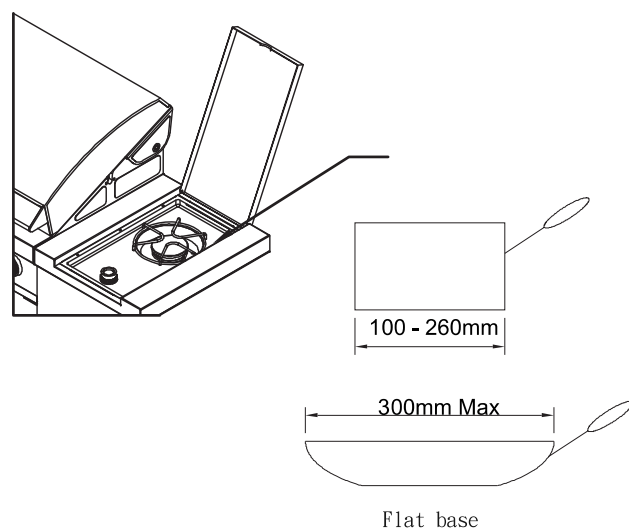

### COOKING WITH HOOD OPEN

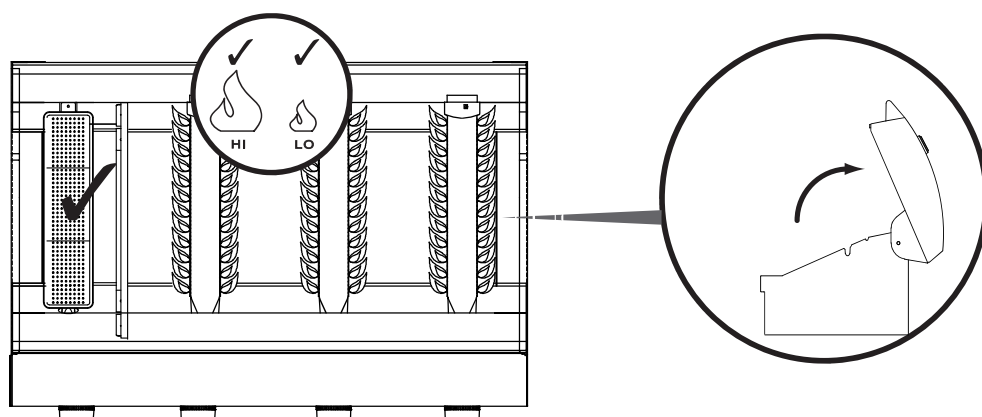

### COOKING WITH HOOD DOWN

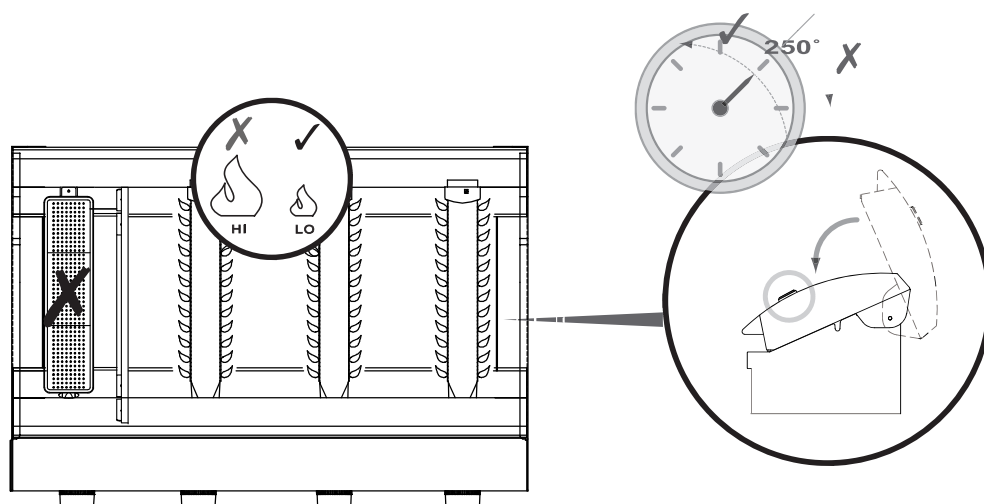

Grand Hall Europe  
PO Box 431  
7570 AK Oldenzaal  
The Netherlands

[www.grandhall.eu](http://www.grandhall.eu)

All specifications are subject to change  
without notice.

Toutes les caractéristiques sont susceptibles  
d'être modifiées sans préavis.

Änderungen ohne vorherige Bekanntgabe  
vorbehalten.

Tutti i dati tecnici possono cambiare  
senza preavviso.

Alle specificaties kunnen zonder voorafgaande  
kennisgeving worden gewijzigd.

Kaikki oikeudet teknisten tietojen  
muutoksiin pidätetään.

Kaikki yksityiskohdat voivat muuttua ilman,  
etta niistä erikseen ilmoitetaan.

Todas las especificaciones están sujetas a  
cambios sin previo aviso.

Todas as especificações estão sujeitas a  
alteração sem aviso.

Moguće su promjene bez prethodnih najava.

Možne so spremembe brez predhodnih najav.

Manufacturer:

Grand Hall Enterprises Co. Ltd.  
9th Fl. No 298 Rueiguang Rd  
Neihu, Taipei, Taiwan

PK00042015A 07 /2015

**(IE) (GB) NOTE:** This information is a guide only. Items included in your BBQ specification may differ depending on region or specific dealer specification.

**(CH) (FR) NOTE:** Ces renseignements sont donnés à titre indicatif. Il est possible que les articles inclus dans les spécifications de votre barbecue diffèrent selon la région ou les caractéristiques stipulées par le concessionnaire.

**(AT) (CH) (DE) ANMERKUNG:** Diese Anleitung dient nur zu Informationszwecken. Einzelteile der Grillspezifikation sind unter Umständen verschieden entsprechend der Vertriebsregion oder bestimmten Händleranforderungen.

**(CH) (IT) AVVERTENZA:** Queste informazioni hanno il valore di guida soltanto. Gli articoli compresi nelle caratteristiche tecniche del barbecue potrebbero variare a seconda della regione o del concessionario.

**(BE) (NL) ATTENTIE:** Deze informatie is alleen bedoeld als gids. Onderdelen in uw BBQ specificatie en pakket kunnen per regio of per dealer verschillen.

**(SE) ANM.:** Denna information är endast avsedd som handledning. Specifikationer för grillen kan variera regionalt eller beroende på de krav som olika återförsäljare har.

**(FI) HUOMATKAA:** Nämä tiedot ovat pelkästään suuntaa antavia. Ostamanne grillin yksityiskohdat voivat olla erilaiset paikkakunnan tai erityisten myyjäkohtaisten yksityiskohtien mukaan.

**(ES) NOTA:** Esta información es una guía únicamente. Es posible que las indicaciones incluidas en las especificaciones de su Asador sean diferentes según la región o las especificaciones específicas del representante.

**(PT) NOTA:** Esta informação é simplesmente um guia. Os itens incluídos na especificação do seu BBQ poderão diferir dependendo da especificação da região ou do vendedor específico.

**(DK) NB:** Denne information er kun vejledende. Specifikationer kan variere efter ønske fra forhandler, eller i henhold til nationale regler.

**(NO) NB:** Denne informasjon er kun veiledende. Spesifikasjoner kan variere som stipulert av forhandler, eller i henhold til nasjonale krav.

**(HR) UPOZORENJE:** Ova uputa služi samo u informativne svrhe. Pojedini dijelovi specifikacije roštilja su različiti od onih koji su propisani Vašim mjestom boravka ili koje su propisali razni distributeri i ovlaštenici za plinske roštilje.

**(SI) OPOZORILO:** Ta navodila so samo informativne narave. Posamezni deli iz specifikacije žara so lahko različni od tistih, kateri so predpisani v vaši regiji ali katere so predpisali distributerji in pooblašeni zastopniki za plinske žare.